

**BLS BackLight aluminium**  
LED backlight - incident light illumination

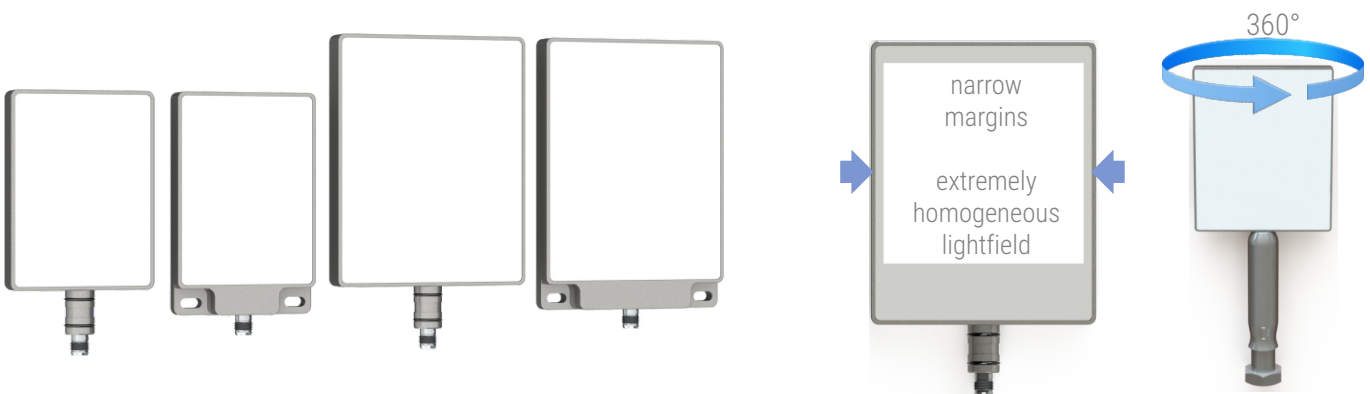

**Controller** inside      **Standard connection M8**  
Triggermodus      **DIN EN 61076-2-104**  
**inside**

Compact LED backlight for the highest quality standards in the pharmaceutical industry, medical technology, diagnostics as well as in the food and cosmetics industry. The **extremely homogeneous lightfield** provides best results in camera-supported industrial image processing. Minimal energy consumption with optimal illumination.



powerful, durable, compact - Made in Germany

**brief description**

**NEW lighting technology inside - 20% more light intensity\*.**  
LED backlight with integrated constant current source:  
The homogeneous lightfield of the backlight has a great influence on the quality of representation, the productivity and the result of the entire quality assurance system.  
Further features of this backlight are the robust, compact, cleaning-optimised design as well as a high manufacturing quality. The lightfield size is adjustable for different applications within a module grid of 25 mm.  
Other sizes and versions (e.g. also without integrated controller S1) are available on request.

\*except infrared

**20 % more light intensity!**

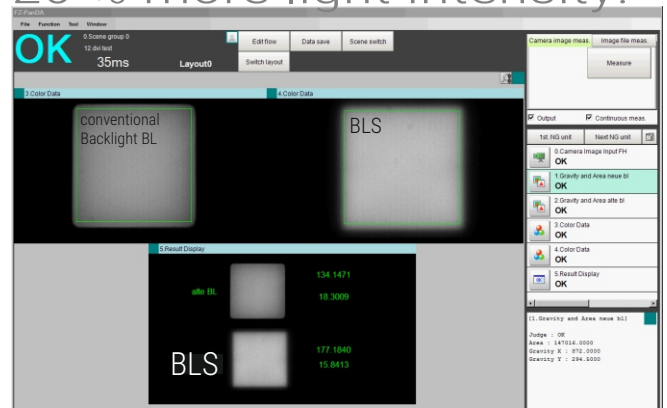



## features

- optimised, homogeneous lightfield
- constant brightness by integrated controller (standard version) or external controller (special version S1)
- strobe mode for higher intensity
- lightcolours: red (RT) / white (WS) / blue (BL) / infrared (IR)
- anodised aluminium housing (natural)
- lightfield plate acrylic glass (PMMA) diffuse (AD) / glass diffuse (GD)
- mounting adapter D12 x 18 mm (model D12)
- slotted hole mounting M4 (model LI4)

## technical data standard version

supply voltage:	24 VDC ( $\pm 10\%$ )
power continuous operation:	depending on the version and light source
trigger time max. (Ti):	10 ms
trigger/pause time (Ti/Tp):	1/10
service life (MTBF):	min. 20.000 h
ambient temperature:	0 °C ... 40 °C
protection class:	IP69K
UL-complaint	



## mounting

mounting adapter for D12  
54,5 x 17,5 x 15 mm  
2xM5 / natural anodised aluminium  
STH-ID: 7000 54 60

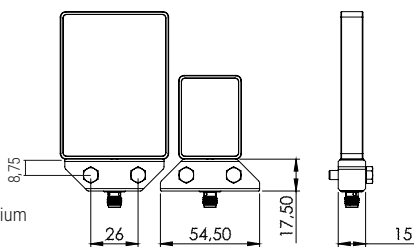

## electrical connections

standard version with controller (constant current source) sensor plug M8 / 4-pole (DIN EN 61076-2-104)

PIN	colour	description
1	brown	supply voltage 24VDC
2	white	operating selection: 0V=continuous operation / +24V=strobe mode
3	blue	0V GND
4	black	trigger signal strobe mode

special version S1 without controller  
sensor plug M8 / 4-pole (DIN EN 61076-2-104)

PIN	colour	description
1	brown	supply voltage constant current source e.g. BR01-2A)
2	white	N.C.
3	blue	0V GND
4	black	N.C.



version S1 without controller may only be operated with constant current source BR01-2A.

## areas of application

- pharmaceutical industry
- medical technology
- diagnostics
- food industry
- cosmetics industry
- packaging industry

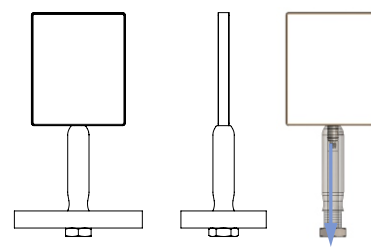

BLS mounting, angle adjustable  
with cable gland  
ETW pharmaceutical mounting D25/M20  
L 50 - 250 mm

other mounting systems available as accessories.